

## XLF



- ▶ Suitable for handling large and heavy sheets, such as glass and metal, with a flat or slightly concave surface.
- ▶ Friction pattern increases safety and capability to handle tilted or standing glass/metal sheets.
- ▶ Double lip design increases safety against overload or tear on the outer lip.
- ▶ Durable and abrasive resistant material reduces the risk for marks.
- ▶ Flat mounting plate facilitates customized mounting interfaces.
- ▶ Auxiliary port, suitable for vacuum sensing or efficient blow-off/release.

### Lifting forces & technical data

Model	Lifting force* vertical to the surface, N, at vacuum level			Lifting force parallel to the surface, N, at vacuum level			Volume cm <sup>3</sup>	Min. curve radius mm	Max. vertical movement mm	Weight g
	40 -kPa	60 -kPa	90 -kPa	40 -kPa	60 -kPa	90 -kPa				
XLF150	330/520	500/770	780/1130	281	425	663	145	500	8	362
XLF200	760/1030	1130/1510	1720/2200	646	961	1462	275	800	8	792
XLF250	1310/1640	1950/2460	2870/3540	1114	1658	2440	435	1300	8	1280
XLF300	2150/2620	3200/3760	4630/5450	1828	2720	3936	666	1900	8	2035

\*Inner/Outer lip

### Material specifications

Material	Colour	Hardness °Shore A	Temperature range °C
Nitrile-PVC, NPV	Black	60	0-90

### Material resistance

Material	Wear resistance	Oil	Weather & ozone	Hydrolysis	Petrol	Concentrated acids	Alcohol	Oxidation
Nitrile-PVC, NPV	Excellent	Excellent	Good	Good	Excellent	Fair	Good	Good

### Ordering information

	Complete suction cups	Art. No.
A	Suction cup XLF150.30.62UA Nitrile-PVC, G1/2" female	0127131
B	Suction cup XLF200.30.62UA Nitrile-PVC, G1/2" female	0127132
C	Suction cup XLF250.30.62UA Nitrile-PVC, G1/2" female	0127133
D	Suction cup XLF300.30.62UA Nitrile-PVC, G1/2" female	0127134

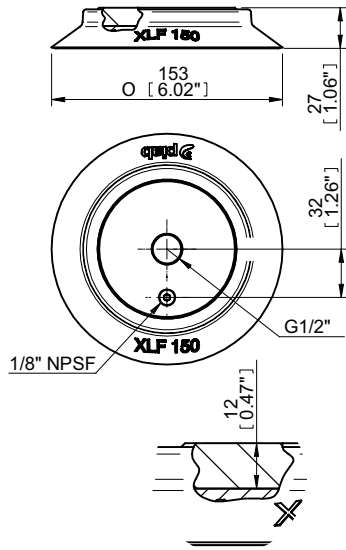

A

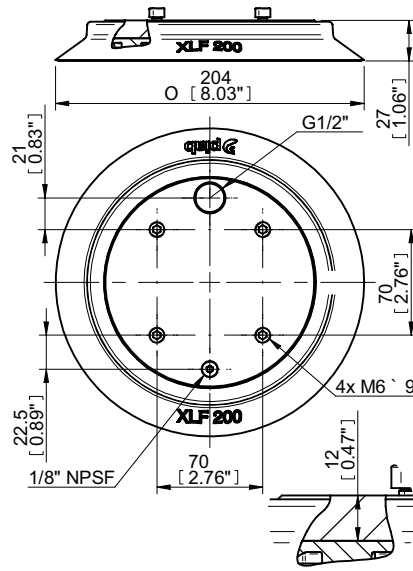

B

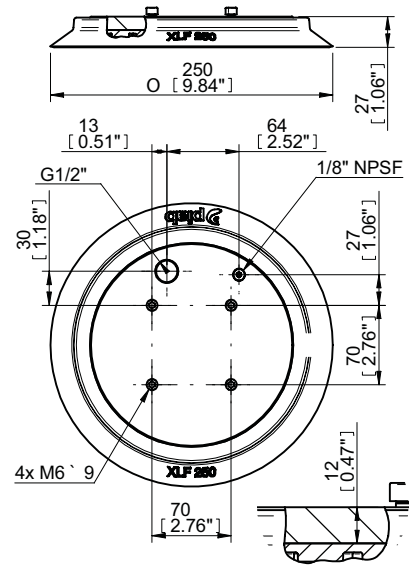

C

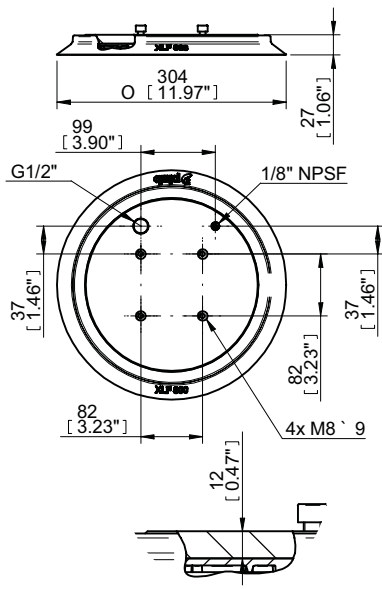

D